

# ARCTIKO INT SF 150

true cooling specialists



## LOW TEMPERATURE CHEST FREEZER I

STORES YOUR SAMPLES UNDER OPTIMAL CONDITIONS

The single compressor technology provides reliable low temperature freezing and high temperature uniformity.

### ► COOLING SYSTEM

Arctiko's SF 150 utilizes our single compressor technology. This means fewer mechanical components taking up space and lowering unnecessary heat and noise dissipation.

The technology ensures the best possible storage capacity per square meter of any chest freezer models in the market.

With Arctiko, you are maximizing the amount of samples you can store, while retaining the best possible cooling performance.

### ► OPTIMIZED STORAGE CAPACITY

The freezer has optimized internal storage for the best overview. With the standard included stackable basket and the optional stainless steel front rack storage system the samples will be easy accessible at any time.

The freezer also has a premade access port with no extra cost involved, making it easier to monitor or inspect the unit with external probes.

### ► FILTERLESS CONSTRUCTION

Our filterless construction makes cleaning unnecessary. The evaporator coils are spaced so far apart that dust will not be trapped and obstruct the airflow.

The filterless construction eliminates the need for filters entirely, saving you maintenance time and cost.



SF 150\* ▲



SINGLE COMPRESSOR SYSTEM



FILTERLESS CONSTRUCTION



NOISE REDUCTION TECHNOLOGY



Optimal storage capacity and overview of the stored samples with the baskets.



The key lock on the handle is a standard feature in our SF Series for optimal security for your samples.

\* The pictures shown are for reference only, actual product size may vary. Please read the dimensions of the product in the specifications.

# ARCTIKO INT SF 150

true cooling specialists

OPTIONAL FEATURES

The ARCTIKO SF 150 model supports following optional features:

- Temperature chart recorder
- Rollers on metal frame
- GSM alarm module
- Voltage converter
- Voltage stabilizer
- Racks & boxes
- Jumbo basket
- Basket

MAIN DIMENSIONS

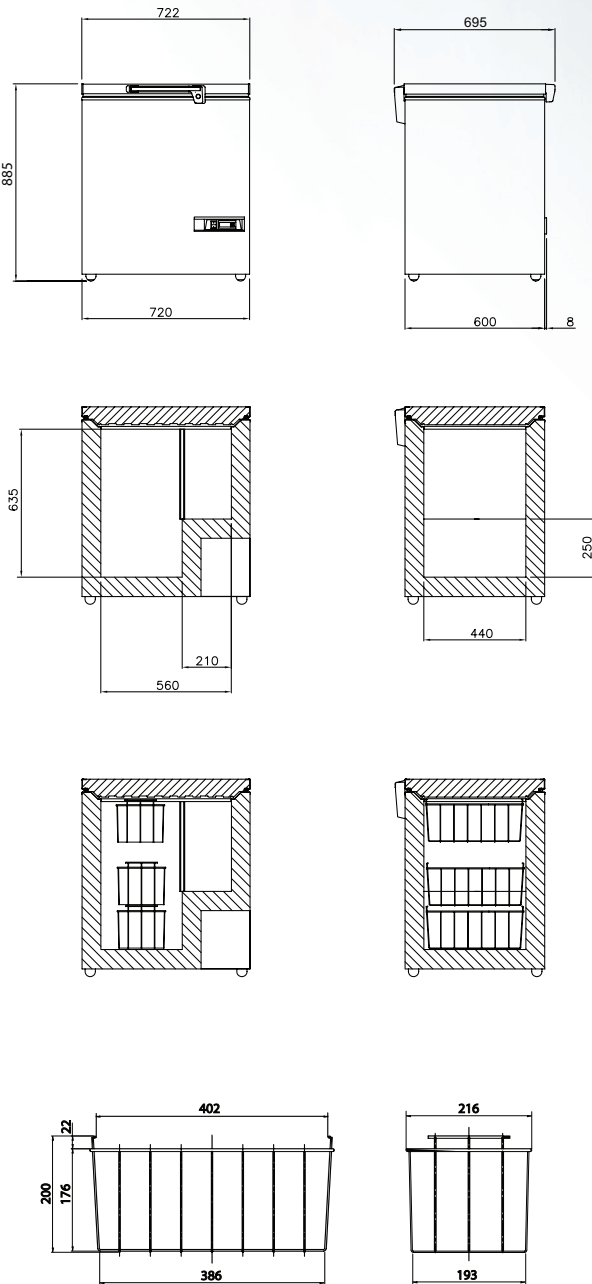

CERTIFICATES



MODEL	SF 150
Item code	US-SUF150
Temperature range (°C)	-30 / -60
Temperature range (°F)	-22 / -76
Max. ambient temperature (°C)	25
Max. ambient temperature (°F)	77
Capacity (L)	133
Capacity (cu. ft.)	4,7
Exterior dimensions WxDxH (mm)	722x708x890
Exterior dimensions WxDxH (inches)	28,43x27,87x35,04
Interior dimensions WxDxH (mm)	560x440x635
Interior dimensions WxDxH (inches)	22,05x17,32x25,00
Weight (kg)	55
Weight (lbs)	121
Insulation (mm)	80
Insulation (inches)	3,16
Cooling technology	static
Controller model / probe type	XR30CX / PT1000
Power	
Power supply (V)	110
Frequency (Hz)	60
Power consumption (kWh/24h)	6,6
AMP (A)	5,0
Power (Watt)	420
Horse power (HP)	3/8
Alarm functions	
Alarm display as text - not codes	no
Visual / acoustic alarm	yes
Power failure alarm	no
Adjustable high / low temperature alarm	yes
Open door alarm	no
Probe failure alarm	yes
Low battery alarm	no
Compressor failure alarm	no
Battery backup for alarms (approx. hrs.)	no
Data logging & external connection	
Voltage free contact for remote alarm (e.g. GSM alarm module)	yes
Electronic data logger	no
RS 485 port	no
USB port for software update & data download	no
Temperature chart recorder	optional
Display features	
Display type	LED display with touch buttons
Number of optional reference probes	no
Password protection for turning unit on / off	no
Temperature graph on display	no
Other features	
Automatic defrost	no
Vacuum release port	no
Access port for external probe etc. (int. diameter mm)	12
Access port for external probe etc. (int. diameter inches)	0,47
Light	no
Lock with key	yes
Castors (total pcs) / castors with brake (pcs)	4 / optional
Fixed feet (pcs) / levelling feet (pcs)	no
Sub lids / inner doors (pcs)	0
Baskets (pcs)	1
Max. no. of baskets (pcs)	3
Max. load per basket (kg)	14,5
Max. load per basket (lbs)	32
Total capacity of 50 mm / 2 inch boxes (pcs)	117
Total capacity of 75 mm / 3 inch boxes (pcs)	84
Total capacity of 96 mm / 3,8 inch boxes (pcs)	54
Refrigeration & cabinet	
Number of compressors	1
Refrigerant	EP88
Interior cabinet material	prepainted steel
Exterior cabinet material	prepainted steel
Colour (exterior cabinet)	white
Foam type	polyurethane
VIP vacuum insulated panels	no
Shipping	
Shipping weight (kg)	85
Shipping weight (lbs)	187
Shipping dimensions WxDxH (cm)	81x76x109
Shipping dimensions WxDxH (inches)	31,9x29,9x42,9
Shipping volume (m <sup>3</sup> )	0,82
Shipping volume (cu. ft.)	28,96