

# ARCTIKO LR 1350

true cooling specialists

2°C to 8°C

## BIOMEDICAL REFRIGERATOR

With its low energy consumption, Arctiko's eco-friendly LR series offers flexibility, security, and reliability for users. The Carel controller features an integrated data logger, which can be accessed via Bluetooth.

### ► INTEGRATED DATA LOGGER

Combining accurate temperature monitoring for optimal sample storage and regulatory compliance, the integrated data logger empowers you with on-the-go control via detailed graphs, alarms, and settings accessible through your phone's Bluetooth connection to the unit's display.

### ► FORCED AIR COOLING

Forced air cooling provides excellent temperature stability. Forcing the airflow around the stored items ensures quick temperature recovery after door openings.

### ► KEY LOCK SECURITY

Equipped with a secure key lock, providing an added layer of protection for valuable contents and preventing unauthorized access. This feature ensures the integrity and confidentiality of stored items, making it ideal for environments where security is paramount.

### ► ENVIRONMENTALLY FRIENDLY REFRIGERANT

This device uses refrigerants with low Ozone Depletion Potential (ODP) and Global Warming Potential (GWP), supporting environmentally conscious operation while maintaining optimal performance and safety standards.



The Carel controller features Bluetooth connection, visual and acoustic alarms, high/low-temperature alarms, open-door alarms and a data logger.

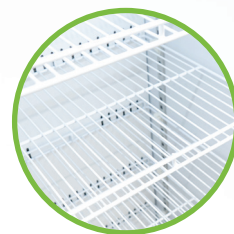

The shelves are easily adjustable to offer the best flexibility for your storage needs.



This model features durable, cost saving LED lighting for better overview of your samples.



DATA LOGGER



FORCED AIR COOLING



ADJUSTABLE SHELVES



VARIOUS SAFETY FEATURES

# ARCTIKO LR 1350

true cooling specialists

The ARCTIKO PR, LR and LF series includes the following features, and more:

- Forced Air Cooling
- Low Energy Consumption
- Key Lock on Door
- Carel controller
- Remote Alarm Interface
- Monoblock Technology
- Eco Friendly Refrigerant

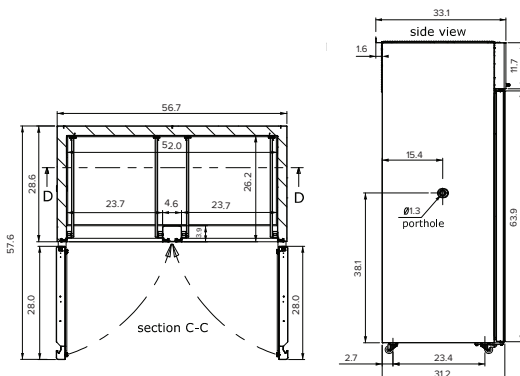
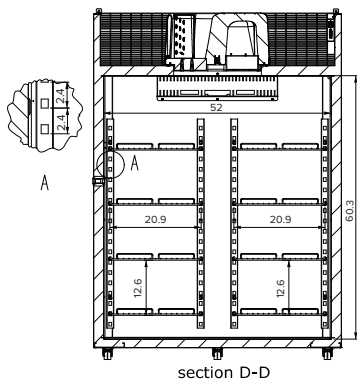
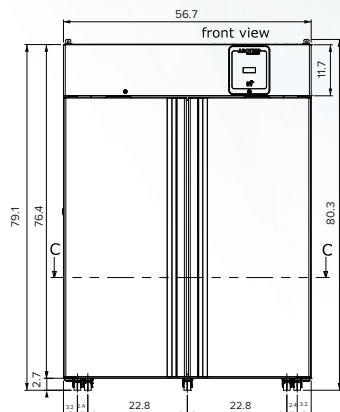

MODEL		LR 1350
Main specifications	Item code	1600027
	Temperature range (°C)	2°C to 8°C
	Max Ambient temperature (°C)	40 °C
	Capacity (L)	1348
	Capacity (cu.FT)	48
	Exterior dimensions WxDxH (mm)	1448x787x2007
	Interior dimensions WxDxH (mm)	1321x660x1524
	Weight (kg)	220
	Insulation (mm)	60
Power	Cooling technology	Forced Air
	Controller model / probe type	Carel IJS / NTC
	Power supply (V)	115
	Frequency (Hz)	60
	Power consumption (kWh/24h)	3.85
	AMP (A)	5.4
Alarm functions	Power (Watt)	470
	Horsepower (HP)	1/3
	Visual / acoustic alarm	Yes / Yes
	Power failure alarm	Yes
	Adjustable high / low-temperature alarm	Yes / Yes
	Open door alarm	Yes
Data logging & external connection	Probe failure alarm	Yes
	Low battery alarm	Yes
	Voltage-free contact for remote alarm (e.g. GSM alarm module)	Yes
Display features	Bluetooth data download	Yes
	Electronic data logger	Yes
	Lockable display to prevent accidental shutdowns	Yes
Other features	Temperature Graph Available via app	Bluetooth
	Number Of Optional Reference Probes	2
	Automatic defrost	Yes
	Vacuum release port	Yes
	Access port for external probe etc.	Yes
	Light	Yes
	Lock with key	Yes
	Castors (total pcs) / castors with brake (pcs)	6 / 2
	Fixed shelves (pcs) / adjustable shelves (pcs)	6
Refrigeration & cabinet	Max. no. of shelves / recommended max. no. of shelves (pcs)	12
	Max Load Per Shelf (lb)	99
	Number of compressors	1
	Refrigerant	R290
	Interior cabinet material	Hot-Dipped Galvanized Steel, Anticorrosion Treated, PVC Film Coated
	Exterior cabinet material	Hot-Dipped Galvanized Steel, Anticorrosion Treated, PVC Film Coated
Shipping	Colour (exterior cabinet)	White
	Foam type	Cyclopentane Polyurethane
	Shipping weight (kg)	241
Shipping	Shipping dimensions WxDxH (mm)	1524x914x2210
	Shipping volume (m³)	3.10